

WELCOME TO MADISON!



Our warm welcome to NSGIC’s 17th Annual Conference. NSGIC’s annual conferences have developed a tradition of days packed with information, discussion, debate and a bit-of-fun. Oh, and not to mention it, but we always have plenty of good food too. This year’s conference will not be an exception to what you have come to expect from NSGIC each year — the roll call of states, state caucuses, presentations by sponsors, reports on unique state activities, and plenty of time for networking with others.

Our theme this year, “*Moving Forward: Locally Grown, Nationally Organized*” captures a concept long recognized by NSGIC members, and that is we continue to move the geospatial world forward through focus on creating and maintaining information locally, while at the same time recognizing that our investments of time and resources are best maximized through national collaboration and cooperation. This theme is particularly appropriate for this conference in Wisconsin considering this state’s heritage of building state programs through the support and involvement of those at the local level.

Several special evening events are lined-up this week. On Tuesday, the Pyle Center, located on the University of Wisconsin Campus near the shores of beautiful Lake Mendota, will be the site of dining and musical entertainment. On Wednesday evening a new event for the NSGIC, “The Taste of the Town” will provide a “host” to lead you to your choice of one of the city’s renowned restaurants. Each evening NSGIC’s Hospitality Suite will be open in the Promenade Lounge, located a block from the hotel in the new and sparkling Overture Center for the Arts. Each night the suite will feature a variety of locally produced Wisconsin beverages.

NSGIC continues to be a national leader in advocating new solutions and approaches to state and national geospatial challenges. This year’s conference gives you the opportunity to continue the dialog on existing issues and to identify, discuss and debate new ideas. While staying involved in the business of the conference is crucial, we hope that you can find a little time to explore and enjoy this capital city. Madison lies on an isthmus between Lakes Mendota and Monona, surrounded by much natural beauty. This is a city frequently named among the best in the nation to live, work, and play.

While here, we hope you experience much, learn a lot, gather new ideas, and expand your network of professional associates. Welcome!

A handwritten signature in cursive script that reads "Rick Memmel".

Rick Memmel
NSGIC Conference Manager

A handwritten signature in cursive script that reads "Ted Koch".

Ted Koch
Wisconsin State Cartographer

HOTEL FLOORPLAN

Madison Concourse Hotel Madison, Wisconsin

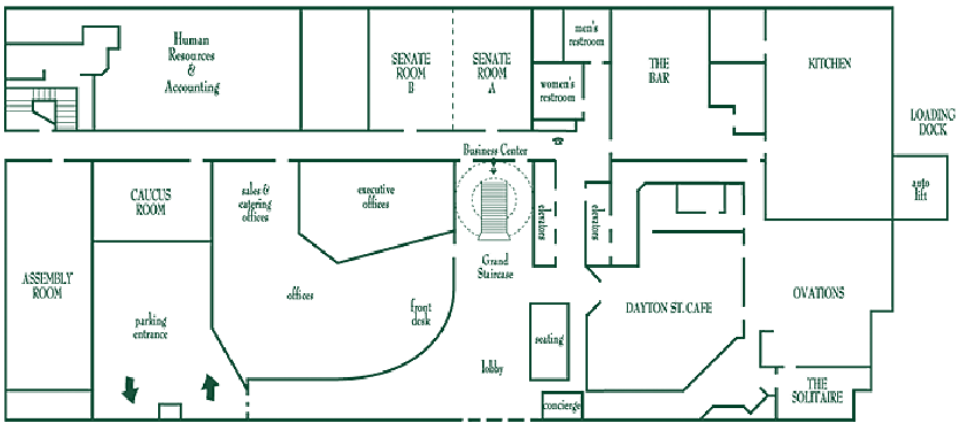
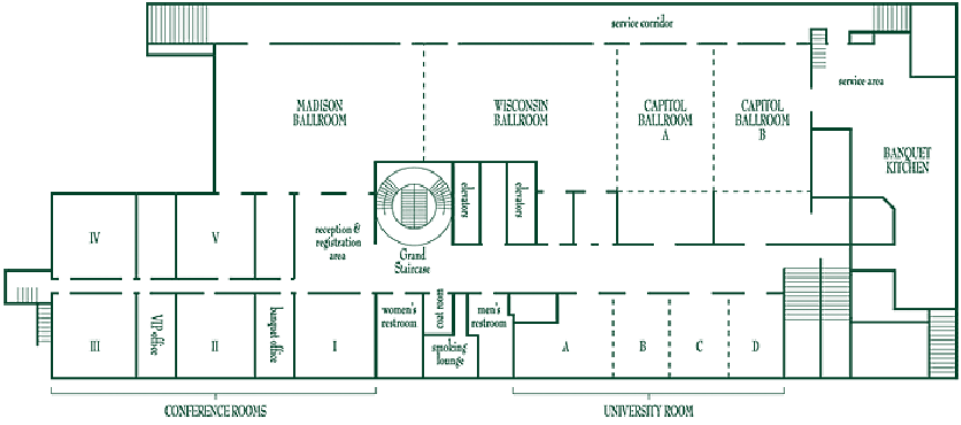

OFFICERS & DIRECTORS

2007 Conference Committee

Ted Koch, University of Wisconsin (Chairperson)
Rick Memmel, NSGIC Conference Manager
Nathan Bentley, Ada County, Idaho
Bill Burgess, NSGIC Washington Liaison
Pat Cummins, ESRI
Stu Davis, State of Ohio
Rick Hammond, Woolpert
Jim Lacy, University of Wisconsin
Kenny Miller, State of Maryland
Dave Mockert, GeoAnalytics
Zsolt Nagy, State of North Carolina
Cy Smith, State of Oregon
Tony Spicci, State of Missouri
Gene Trobia, State of Arizona
Dick Vraga, US Geological Survey

NSGIC Board of Directors

President:

Stu Davis, State of Ohio

President Elect:

Cy Smith, State of Oregon

Past President:

Tony Spicci, State of Missouri

Directors:

David Brotzman, State of Vermont
Jill Saligoe-Simmel, Indiana Geographic Information Council, Inc.
Michael Mahaffie, State of Delaware
Will Craig, State of Minnesota
Learon Dalby, State of Arkansas
Jim Knudson, Commonwealth of Pennsylvania

Secretary:

Nathan Bentley, Ada County, Idaho

Treasurer:

Ivan Weichert, State of Kansas

Washington Liaison:

Bill Burgess

NSGIC Headquarters Staff

Fred Stringfellow
Association Manager

Diane Vaughnley
Director of Meetings and Member Services

Logan Rosenberg
Association Coordinator

Amy Chetelat
Director of Finance

SCHEDULE AT-A-GLANCE

	Sunday, Sept. 23	Monday, Sept. 24
7 a.m.		Registration (Ballroom Foyer) 7 a.m. – 5 p.m. Breakfast (Madison Ballroom) 7 a.m. – 8:15 a.m.
8 a.m.		Welcome & Opening Comments 8:15 a.m. – 8:45 a.m. Roll Call of States 8:45 a.m. – 12 noon
9 a.m.		
10 a.m.	NSGIC Board Meeting (Senate Room) 10 a.m. – 12 noon	Break & Sponsor Exhibits (University Ballroom and Foyer) 10 a.m. – 10:30 a.m.
11 a.m.	Registration Opens (Ballroom Foyer) 11 a.m. – 6 p.m.	
12 p.m.	Lunch (Capitol Ballroom) 12 noon – 1 p.m.	Lunch (Madison Ballroom) 12 noon – 1 p.m.
1 p.m.	State Members Caucus (Capitol Ballroom) 1 p.m. – 5:15 p.m.	Keynote Presentation 1 p.m. – 2 p.m.
2 p.m.		USGS NGPO Meeting (Assembly Room) 2 p.m. – 3 p.m. Tele Atlas Presentation 2 p.m. – 2:30 p.m. Board Candidates Speak 2:30 p.m. – 3 p.m.
3 p.m.	Break (Capitol Ballroom) 3 p.m. – 3:30 p.m.	Group Photo 3 p.m. – 3:30 p.m. Break & Sponsor Exhibits (Univ. Ballroom and Foyer) 3:30 p.m. – 4 p.m.
4 p.m.		Imagery for the Nation 4 p.m. – 4:30 p.m. State Enterprise GIS 4:30 p.m. – 5:30 p.m.
5 p.m. and after	New Member Orientation (Capitol Ballroom) 5:15 p.m. – 6 p.m. Opening Reception and Dinner (Madison Ballroom) 6 p.m. – 7:30 p.m. Coastal Caucus (Senate Room) 7:30 p.m. – 9:30 p.m. Hospitality Suite (The Overture Center) 9:30 p.m. – 12 pm	Sponsor Reception (Univ. Ballroom and Foyer) 6 p.m. – 8 p.m. Corporate Leadership Council Meeting (The Overture Center) 8 p.m. – 9 p.m. Fifty States Initiative Meeting (Assembly Room) 8 p.m. – 9:30 p.m. Hospitality Suite (The Overture Center) 9:30 p.m. – 12 a.m.

All sessions will be held in the Capitol Ballroom on the second level unless otherwise noted.

Tuesday, Sept. 25	Wednesday, Sept. 26	Thursday, Sept. 27
<p>Registration (Ballroom Foyer) 7 a.m. – 5 p.m.</p> <p>Breakfast (Madison Ballroom) 7 a.m. – 8:30 a.m.</p> <p>Sponsor Breakfast (Senate Room) 7 a.m. – 8:30 a.m.</p>	<p>Registration (Ballroom Foyer) 7 a.m. – 5 p.m.</p> <p>Breakfast (Madison Ballroom) 7 a.m. – 8:30 a.m.</p>	<p>Registration (Ballroom Foyer) 7 a.m. – 5 p.m.</p> <p>Breakfast (Madison Ballroom) 7 a.m. – 8:30 a.m.</p>
<p>Floodplain Mapping 8:30 a.m. – 9 a.m.</p>	<p>Keynote Panel 8:30 a.m. – 9:30 a.m.</p>	<p>Federal Contracts Open to State & Local Partners 8:30 a.m. – 9 a.m.</p>
<p>Michael Baker, Jr., Inc 9 a.m. – 9:30 a.m.</p> <p>NSGIC Issues Briefing 9:30 a.m. – 10 a.m.</p>	<p>AmericaView 9:30 a.m. – 10 a.m.</p>	<p>Vertical Control Issues 9 a.m. – 9:30 a.m.</p> <p>Great Lakes Regional Information Network 9:30 a.m. – 10 a.m.</p>
<p>Break and Sponsor Exhibits (Ballots Due) (Univ. Ballroom and Foyer) 10 a.m. – 10:30 a.m.</p> <p>Business Meeting 1 10:30 a.m. – 12 noon</p>	<p>Break and Sponsor Exhibits (Univ. Ballroom and Foyer) 10 a.m. – 10:30 a.m.</p> <p>GIS In Healthcare 10:30 a.m. – 11:30 a.m.</p>	<p>Break & Sponsor Exhibits (Univ. Ballroom and Foyer) 10 a.m. – 10:30 a.m.</p> <p>Executing Better RFP's 10:30 a.m. – 11:30 a.m.</p>
	<p>Intermap Technologies 11:30 a.m. – 12 noon</p>	<p>Gold Sponsor Presentations 11:30 a.m. – 11:45 a.m.</p> <p>Funding Strategies for State-wide Orthophoto Projects 11:45 a.m. – 12:15 p.m.</p>
<p>Lunch (Madison Ballroom) 12 noon – 1:30 p.m.</p>	<p>Lunch (Madison Ballroom) 12 noon – 1:30 p.m.</p>	<p>Lunch (Madison Ballroom) 12:15 p.m. – 1:30 p.m.</p>
<p>Shared Services 1:30 p.m. – 2:30 p.m.</p>	<p>GIT Governance 1:30 p.m. – 2 p.m.</p>	<p>Business Meeting 2 1:30 p.m. – 2 p.m.</p>
<p>Gold Sponsor Presentations 2:30 p.m. – 3:30 p.m.</p>	<p>Gold Sponsor Presentations 2 p.m. – 3 p.m.</p>	<p>State Caucus Part 2 2 p.m. – 5 p.m.</p> <p>USGS NGPO Meeting (Assembly Room) 2 p.m. – 5 p.m.</p>
<p>Break and Sponsor Exhibits (Univ. Ballroom and Foyer) 3:30 p.m. – 4 p.m.</p>	<p>Transportation for the Nation 3 p.m. – 3:30 p.m.</p> <p>Break and Sponsor Exhibits (Univ. Ballroom and Foyer) 3:30 p.m. – 4 p.m.</p>	<p>Break and Sponsor Exhibits (Univ. Ballroom and Foyer) 3:30 p.m. – 4 p.m.</p>
<p>Unique State Activities 4 p.m. – 5:30 p.m.</p>	<p>Homeland Security 4 p.m. – 5:30 p.m.</p>	
<p>Offsite: Pyle Center 6 p.m. – 9 p.m.</p> <p>Hospitality Suite (The Overture Center) 9:30 p.m. – 12 a.m.</p>	<p>Dinner on own or Taste of the Town 6 p.m.</p> <p>Hospitality Suite (The Overture Center) 9:30 p.m. – 12 a.m.</p>	<p>New Board Meeting (Senate Room) 6 p.m. – 9 p.m.</p> <p>Hospitality Suite (The Overture Center) 9:30 p.m. – 12 a.m.</p>

CONFERENCE AGENDA

All sessions will be held in Capitol Ballroom on the second level unless otherwise noted.

Sunday, Sept. 23

10 a.m. – 12 noon
NSGIC Board Meeting
Moderator: Stu Davis, State of Ohio,
NSGIC President
Senate Room, Lobby Level
Open to all

11 a.m. – 6 p.m.
Registration Opens
Ballroom Foyer, Second Level

12 noon – 1 p.m.
Lunch Provided
Capitol Ballroom, Second Level

1 p.m. – 5:15 p.m.
State Members Caucus
Moderators: Bill Burgess, NSGIC
Washington Liaison; and Tony Spicci,
State of Missouri
Capitol Ballroom, Second Level

This is the first of two State Caucuses where state and local government members will meet in private to further refine NSGIC's position on important issues. The state representatives will be briefed on and discuss current NSGIC initiatives to incorporate their thoughts as we plan for future activities. The states will also discuss and receive briefings on current "hot topics" that are of general interest. At the end of the State Caucus (~5:10 p.m.) our Gold and Platinum sponsors will be asked to introduce their attendees and offer a few words about their goals for this conference.

3 p.m. – 3:30 p.m.
Break
Capitol Ballroom, Second Level

5:15 p.m. – 6 p.m.
New Member Orientation
Moderator: Tony Spicci, State of Missouri
Capitol Ballroom, Second Level

New members and others unfamiliar with NSGIC are encouraged to attend this session which will provide an overview of NSGIC and its activities. There will be plenty of time for questions and discussion so that everyone will learn how to take full advantage of the conference and their membership in NSGIC.

6 p.m. – 7:30 p.m.
Opening Reception and Buffet Dinner – "Meet the Candidates"
Madison Ballroom, Second Level

Attendees are invited to meet and discuss issues in a casual environment with the candidates running for office in the 2007 NSGIC Board Election. There will be no formal presentations by the candidates involved.

7:30 p.m. – 9:30 p.m.
Coastal Caucus
Moderators: Bill Burgess, NSGIC
Washington Liaison
Senate Room, Lobby Level

NSGIC and the NOAA Coastal Services Center (CSC) are working together to host the first Coastal Caucus. The goals for this effort are 1) to achieve a better understanding of the importance of geospatial technologies to coastal issues, 2) to connect the geospatial community and coastal resource community in each state, 3) to provide a better understanding of the services provided by NOAA CSC, and 4) to determine if the Coastal Caucus should continue in a more formal manner. This session will begin with a series of short presentations on relevant topics for the geospatial community that deal with geospatial issues. The presentations will be followed by a discussion period that will let us know if it's time to "fish or cut bait."

MEETING AGENDA:

Presentations (1 hour)

- Opening Comments
- NOAA CSC will describe the trends they see in the application of geospatial technologies within Coastal states and the services that they provide
- Several states will provide a brief overview of relevant coastal projects and successes
- Introductions of stakeholder organizations and their goals for the Caucus

Discussion (1 hour)

- Open discussion about the value of formalizing the Coastal Caucus
- What actions need to be taken to improve communications and working relationships between the Coastal Resource Management Community and the Geospatial Community
- Wrap-up and Announcements

9:30 p.m. – 12 midnight

Hospitality Suite (open to all registrants)

Promenade Lounge – The Overture Center for the Arts

The Overture Center is one block from the Concourse. Exit the front door of the hotel, turn left and walk down West Dayton St. to the intersection with State St. The Overture Center is the building straight ahead with the glass dome. Enter the front door and take the stairs or elevator in the Lobby to the second floor. The Promenade Lounge is to the left. – Thank you to this evening's sponsor: **SAS/GeoAnalytics, Inc.**

Monday, Sept. 24

7 a.m. – 5 p.m.

Registration

Ballroom Foyer, Second Level

7 a.m. – 8:15 a.m.

Breakfast Provided

Madison Ballroom, Second Level

8:15 a.m. – 8:45 a.m.

Welcome & Opening Comments

Moderators: Ted Koch, State of Wisconsin; Stu Davis, State of Ohio, NSGIC President; Rick Memmel, NSGIC Conference Manager

Capitol Ballroom, Second Level

Host State welcome from Wisconsin.

8:45 a.m. – 12 p.m.

Roll Call of States

Moderator: Rick Memmel, NSGIC Conference Manager

Each State and Corporate Sponsor will have two minutes to introduce its delegates and give highlights of key activities.

10 a.m. – 10:30 a.m.

Break & Corporate Sponsor Exhibits

University Ballroom and Foyer, Second Level

12 noon – 1 p.m.

Lunch Provided

Madison Ballroom, Second Level

1 p.m. – 2 p.m.

Keynote Presentation – USGS Science Moving Forward: Our Geospatial Foundation

Moderator: Stu Davis, State of Ohio, NSGIC President

Presenter: Mark Myers, Director, US Geological Survey

The USGS is moving forward on a unified science strategy to address the most pressing societal issues of the future. This strategy includes a renewed commitment to strengthen the foundation of geospatial data and topographic maps that are critical to emergency response, Homeland Security, land-use planning and resource management. The Director will present a vision and discuss plans for science and data integration and our National Geospatial Program.

2 p.m. – 3 p.m.

USGS NGPO Meeting

Moderator: John Mahoney, US Geological Survey

Assembly Room, Lobby Level

CONFERENCE AGENDA

2 p.m. – 2:30 p.m.

Platinum Sponsor Presentation: Tele Atlas - “Moving Forward”

Moderator: Cy Smith, State of Oregon
Presenter: John Auble, Director, Government / Utilities / Oil & Gas Markets

In keeping with this year’s NSGIC conference theme: “Moving Forward: Locally Grown, Nationally Organized”, John Auble will discuss how Tele Atlas implements this concept with transportation data, and the lessons learned.

2:30 p.m. – 3 p.m.

Board Candidates Speak

Moderator: Joe Holmes, State of Louisiana

Each candidate for the Board and President-Elect will have an opportunity to speak.

3 p.m. – 3:30 p.m.

Group Photo at State Capitol Steps

3:30 p.m. – 4 p.m.

Break & Corporate Sponsor Exhibits

University Ballroom and Foyer, Second Level

4 p.m. – 4:30 p.m.

Imagery for the Nation: An Update

Moderators: Ted Koch, State of Wisconsin; Bill Burgess, NSGIC Washington Liaison

The Imagery for the Nation (IFTN) proposal continues to be NSGIC’s number one initiative. The proposal has generated much interest and support. Twenty-two states and more than a half dozen national organizations have endorsed the IFTN concept. This session will cover recent IFTN developments including a summary of the recently completed Cost Benefit Analysis, funding status, acquisition plans, and details on the state business plan template.

4:30 p.m. – 5:30 p.m.

State Enterprise GIS

Moderators: Pat Cummins, ESRI; Cy Smith, State of Oregon

This session will explore what it takes to build an enterprise GIS designed to meet diverse business needs of state government. As technol-

ogy changes and expectations of our citizens and decision makers increase our vision of enterprise GIS must also evolve. Enterprise GIS used to be a centralized spatial database and a big computer; now enterprise GIS involves new organizational considerations, working closely with the state CIO, ensuring legislative support, leveraging IT architecture, standing up shared geospatial web services, enabling non-traditional GIS agencies, hosting applications, negotiating service level agreements and much more. This session will showcase model state efforts and discuss strategies for other states to consider.

- **Taking GIS to a New Level, Working with the State CIO**
Presenter: Dennis Goreham, State of Utah

Increase the power and impact of enterprise GIS for the broader state and local community by teaming up with the efforts of the State CIO. Systematically assessing government business processes and identifying common processes has become a standard practice for CIOs. This approach allows the CIO, the GIO, and agency IT Directors to identify opportunities for collaboration at many levels. The GIS community can leverage these efforts to identify those that benefit from geospatial data and functionality to guide development of a shared service approach.

- **Required: Enterprise GIS to Achieve the Governor’s Vision**
Presenter: Kenny Miller, State of Maryland

The Governor gets it! He understands the inherent power of location as an integrator and GIS as a communications, analysis, performance measuring and decision support tool. GIS will be instrumental in standing up BayStat and StateStat, two of Governor O’Malley’s cross agency, priority initiatives. This presentation will share the GIS strategy to build an infrastructure that sup-

ports this vision with the flexibility to grow as new issues and ideas emerge.

- **Achievements in Enterprise GIS, Strategy for Building a State SDI**
Presenters: Jim Knudson & Stacey White, Commonwealth of Pennsylvania

Architecting a State Spatial Data Infrastructure is not a simple thing. Consideration must be given to government access, public access, and building a resilient, high availability environment that is operational when you really need it. Pennsylvania has been able to leverage State Homeland Security Funds and General Funds to build the Geospatial Enterprise Server Architecture (GESA) for government and public safety use. It has also been hardening the existing PSU PASDA State GIS Clearinghouse architecture to enable both organizations to handle 10 TB of PAMAP imagery and LiDAR, and provide some hardware fault tolerance. Pennsylvania will share its experiences and accomplishments in building an interoperable enterprise GIS infrastructure, including enterprise application hosting environment, a centralized enterprise geospatial database. It will also describe how its mapping services and web services are enabling non-GIS agencies and applications to provide better citizen services. Operational strategies and lessons learned will also be discussed.

6 p.m. – 8 p.m.

Sponsor Reception

University Ballroom and Foyer, Second Level

This will be your prime opportunity to meet with all of our sponsors, ask important questions, get “one-on-one” time, gather literature and see demos of their “Latest and Greatest” technologies. Please take the time to thank our sponsors for their help in making NSGIC the organization that it is.

8 p.m. – 9 p.m.

Corporate Leadership Council Meeting

Moderator: Cy Smith, State of Oregon
Promenade Lounge – The Overture Center for the Arts

8 p.m. – 9:30 p.m.

Fifty States Initiative Meeting

Moderator: William Burgess, NSGIC Washington Liaison; Milo Robinson, Federal Geographic Data Committee
Assembly Room, Lobby Level

This meeting is sponsored by NSGIC and the Federal Geographic Data Committee (FGDC). It’s intended to support states in their efforts to implement the Fifty States Initiative. Attendees will be asked to discuss their CAP Category 3 grant projects currently underway and network with other grantees. They will also have an opportunity to explore the support resources that can be provided by FGDC or NSGIC to help ensure the success of their program. This meeting should be attended by all states that have an active CAP Category 3 grant from the FGDC and those that plan to submit a grant request for the 2008 grant cycle. All conference attendees are welcome to attend this meeting.

9:30 p.m. – 12 midnight

Hospitality Suite (open to all registrants)

Promenade Lounge – The Overture Center for the Arts

The Overture Center is one block from the Concourse. Exit the front door of the hotel, turn left and walk down West Dayton St. to the intersection with State St. The Overture Center is the building straight ahead with the glass dome. Enter the front door and take the stairs or elevator in the Lobby to the second floor. The Promenade Lounge is to the left.

CONFERENCE AGENDA

Tuesday, Sept. 25

7 a.m. – 5 p.m.

Registration

Ballroom Foyer, Second Level

7 a.m. – 8:30 a.m.

Breakfast Provided

Madison Ballroom, Second Level

7 a.m. – 8:30 a.m.

Sponsor Breakfast

Senate Room, Lobby Level

One representative from each sponsor will meet with the NSGIC Board members, officers, conference committee and committee chairs to discuss conference issues, ideas, suggestions, and other related topics.

8:30 a.m. – 9 a.m.

Floodplain Mapping – Data Needs

Moderator: Ted Koch, State of Wisconsin; Dick Vraga, US Geological Survey

Presenter: Alan Lulloff, Association of State Floodplain Managers (ASFPM)

FEMA is half way through Flood Map Modernization. This presentation will focus on the Association of State Floodplain Managers (ASFPM) view of the data needed to “modernize” a flood hazard map, data gaps and the future of flood hazard mapping as FEMA moves from Flood Map Modernization to Flood Map Maintenance.

9 a.m. – 9:30 a.m.

Platinum Sponsor Presentation:

Michael Baker, Jr., Inc. – State and National Geospatial Programs

Moderator: Cy Smith, State of Oregon

Presenter: Malcolm Adkins, Client Services Director

Baker will highlight a sampling of recently completed and current state-specific projects and current federal projects that have direct impact at the state level.

9:30 a.m. – 10 a.m.

NSGIC Issues Briefing

Moderator: Bill Burgess, NSGIC Washington Liaison

- **County Priorities**

Speaker: Pedro Flores, GIS Outreach Director, National Association of Counties

This presentation will identify the most significant issues for county government and NACo’s advocacy priorities for the upcoming year. The use of GIS technologies in county governments will be discussed in relation to their major issues.

- **Stakeholder Meetings**

Speakers: Stu Davis, State of Ohio, NSGIC President; Cy Smith, State of Oregon, NSGIC President-Elect

NSGIC first proposed a series of meetings with other organizations that are stakeholders in the NSDI through its 2005 Strategic Plan. To date, meetings have been held during NSGIC and URISA Conferences. Bringing the organizations together provides a forum for discussion on topics that are important within the geospatial community. Positive results are being posted through this series of meetings. You will be brought up-to-date on these efforts during this session.

10 a.m. – 10:30 a.m.

Break and Corporate Sponsor Exhibits (Ballots Due)

University Ballroom and Foyer, Second Level

10:30 a.m. – 12 noon

Business Meeting 1

Moderator: Stu Davis, State of Ohio, NSGIC President

The Business Meeting follows a format prescribed in NSGIC’s bylaws, including the Call to Order, Roll Call of Member States, Approval of Minutes of the Previous Meeting, Reports of Officers, Reports of Standing and Special Committees, Unfinished Business, New Business including resolutions, and adjournment.

12 noon – 1:30 p.m.

Lunch Provided

Madison Ballroom, Second Level

1:30 p.m. – 2:30 p.m.

Shared Services

**Moderator: Pat Cummins, ESRI;
Kenny Miller, State of Maryland**

A technology shift to shared services is a key part of many CIO's State IT strategic plans as a way of streamlining government, improving efficiency and adding value to both state and local governments. GIS data and functionality can be shared through well crafted services matching the goals outlined at a business level in state strategic plans and in more detail in GIS strategic plans. This session will provide information about activities in organizations pioneering these efforts, revealing strategies that can help you to make a successful transition to a shared services architecture.

- **DC Capitalizes on Live GeoServices
Presenter: Barney Krucoff, District of Columbia**

As part of the Mayor's Cap-STAT program DC has integrated "live" geodata services. These data feeds are updated at least daily and include; service requests, crimes, arrests, and various types of regulatory actions and inspections. DC also employs a series of GIS Web Services including; a gazetteer/geocoder, point in polygon analysis, and basic mapping. DC will demonstrate how the centralized data feeds and Web Services are consumed by multiple agencies.

- **Mississippi's Geospatial Clearinghouse, services and Enterprise GIS
Presenter: Cheryl Crawford, State of Mississippi Department of Information Technology Services, GIS Project Manager**

The Mississippi Geospatial Clearinghouse (MGC) provides access to a comprehensive spatial information warehouse of GIS resources of Mississippi for use by government, academia, and the private sector. The State of Mississippi is benefiting from cost

economies by avoiding redundancy in statewide data collection, which had heretofore been a problem. We are also making statewide GIS data available via the web at no cost.

The consumers of our data and site historically had little or no GIS data available. The goal of the MGC is to make the application of spatial information technologies within the State of Mississippi more efficient by eliminating the duplication of spatial data production and distribution through effective cooperation, standardization, communication, and coordination.

- **State's Catalog Cross Agency Data Sharing
Presenters: Zsolt Nagy, State of North Carolina; Steve Grise, ESRI**

NASCIO has created an online catalog of government information exchanges, business processes that require one agency to access information from another. This catalog captures sharing scenarios not in technical specifications but in business terms; documenting data, participants and needs. The desired outcome is a catalog of exchanges from across the country that can be shared and used as a representative set of needed information exchanges, establishing a foundation for building shared services.

2:30 p.m. – 3:30 p.m.

Gold Sponsor Presentations

Moderator: Cy Smith, State of Oregon

- **Fugro EarthData – Myth or Reality? Successful Public – Private Partnerships
Presenter: Anne Hale Miglarese, President**

From the vantage point of a former state and federal government official, as well as the president of a leading mapping company, Fugro EarthData President Anne Hale Miglarese will present her views on building successful public – private partnerships. Her address will explore the ingredients of a mutually

CONFERENCE AGENDA

beneficial public – private partnership and showcase several proven methods to overcome typical challenges such as competing agendas, mistrust, and bureaucracy. She will also speak specifically to building mapping programs and the potential contributions that each party brings to the partnership.

- **ESRI — Break-through Technologies to Make Your Jobs Easier**
Presenter: Pat Cummins, Government Strategist

We will give a very brief overview of key technologies matched to state business needs designed to make it easier for the GIS community to deliver the goods and accomplish their goals. Explore a range of tools to support; rapid deployment of raster imagery, standing up readily consumable geoservices or equipping field workers with mobile tools. The technology is ready and available, are you ready?

- **3001 Inc. — Airborne Solutions for State and Regional Emergency Response**
Presenter: Jay Arnold Vice President, Business Development

Advances in airborne digital sensors and data processing, combined with increased awareness and preparedness, have led to better solutions and improved response capabilities for emergency and disaster response. Airborne LiDAR, digital airborne imagery, and related geospatial services are now relied upon heavily by local, state, and federal response agencies. This briefing provides an overview of the latest practical tools being applied by the airborne services community for emergencies and disasters caused by terrorism, hurricanes, tornadoes, wildfires, and flooding events. Preparedness before an event, planning and response during an event, and assessment and preventive measures post-event can

all be aided through airborne geospatial services as demonstrated and discussed in this presentation.

- **Aero-Metric, Inc. — Emergency Response Partnerships With Federal and State Agencies**
Presenter: Dr. Terry Keating, CTO, and Wisconsin Division Manager

In conjunction with the USGS, Aero-Metric has developed a standing task order to mobilize, fly, process and deliver digital images and elevations within 24-48 hours of a given disaster. Case studies of July 2007 flood mapping in Kansas and the Minnesota I-35 bridge failure will be used to explain the program.

- 3:30 p.m. – 4 p.m.**
Break and Corporate Sponsor Exhibits

University Ballroom and Foyer, Second Level

- 4 p.m. – 5:30 p.m.**
Unique State Activities

Moderator: Nathan Bentley, Ada County GIS Manager

- **Wisconsin Land Information Program**
Presenter: Jason R. Grueneberg, Wisconsin Land Information Association

This session will talk about Wisconsin's unique grassroots approach to building GIS. In 1989, the legislature and the Governor passed Act 31 which created the Wisconsin Land Information Program. Act 31 required the counties to collect a small fee for recording any instrument entitled to be recorded in the office of the Register of Deeds. The fees collected are to be used for land records modernization at the county level. Over the last 18 years, the program has generated millions of dollars statewide and provided all counties a continuing revenue source to modernize land records and build GIS. The WLIP has created a strong local understanding of geospatial technology, a wide array

of products and services developed to meet local needs, and built a strong foundation for Wisconsin Enterprise GIS.

- **Ohio School District Boundary Update**

Presenter: Lane Wood, Assistant Administrator, Enterprise Shared Services Ohio Office of Information Technology

Over the past three years, Ohio has conducted three separate initiatives to update school district boundaries on a statewide basis. Each step has brought Ohio closer to a parcel based school district boundary. This presentation will describe how the initiatives have incrementally increased the accuracy and value of school district boundaries in Ohio.

- **Alaska Statewide Digital Mapping Initiative**

Presenter: Rich McMahon, Alaska Department of Natural Resources

Alaska's Statewide Digital Mapping Initiative is an interagency effort to produce high-resolution, digital base maps of the entire state. Existing topographic maps of Alaska are more than 40 years old, and it's common to find inaccuracies of up to a quarter-mile. Government and military operations and, just as importantly, private entities, need accurate digital base maps to succeed in computerized data environments. This initiative is timely because Alaska is the only state without digital imagery and elevation maps at nationally accepted standards.

- **Pennsylvania — Geospatial Analysis of Threats and Incident Reports (GATIR)**

Presenters: Jim Knudson, Deputy CIO, Environmental Community of Practice, State Geospatial Technologies Coordinator; Stacey White, Director, Geospatial Technologies Office

The Pennsylvania Geospatial Technologies Office has developed

the GATIR application, which leverages the high availability Geospatial Enterprise Server Architecture (GESA) and Enterprise Geospatial Database for use in support of public safety in the Commonwealth. GATIR was developed utilizing the IRRIS framework, which was developed for the Department of Defense, and code shared with other U.S. government entities. More than \$15M has been invested in IRRIS by DoD over the past 9 years. IRRIS won a 2007 ACT/IAC Award in the Intergovernmental Solutions Category.

GATIR began as a result of a 2004 DHS Information Technology Evaluation Program (ITEP) grant, and has been augmented by several DHS State Homeland Security Program (SHSP) grants in 2004 and 2005. The current GATIR Version 3 was deployed in September 2007, integrates real-time weather data from AWS Weatherbug, and adds Severe Weather Alerting and Plume Modeling functionalities.

The Geospatial Technologies Office will discuss how GATIR has evolved over the past 2 years, will attempt to demonstrate the integration of the AWS Weatherbug Real-Time Weather data and Plume Modeling Wizard, and will review the integration strategy, current GATIR development projects, and long-term vision.

- **Michigan — Are We Ready to Transform?**

Presenter: Eric Swanson, Michigan Department of Information Technology

Michigan has instituted a "Balanced" approach to delivering its Spatial IT services through the consolidation of "Enterprise Functions" and by taking an entrepreneurial approach to meeting "Discretionary Demand." Michigan's GIS "fit" within its overall IT consolidation effort will be discussed along with the associated funding model. In addition,

CONFERENCE AGENDA

current key strategic investments will be discussed to meet the growing discretionary demand — i.e. non-traditional GIS technology and human skills.

6 p.m. – 9 p.m.

Dinner at the Pyle Center on the Campus of the University of Wisconsin

On Tuesday evening you are invited to join us for food, music, and relaxation at the Pyle Center scenically located on the shores of beautiful Lake Mendota in the heart of Madison. During the day the Pyle Center, located on the University of Wisconsin Campus, functions as a sophisticated technology center offering spaces for video-conferencing, distance education and training classes. For this evening we will use two of the Center's lovely conference rooms and the glass walled Alumni Lounge overlooking the lake to provide a setting of casual dining on traditional Wisconsin fare. Mid-Life Crisis, a popular Madison band noted for rock-n-roll from the decades, will provide the evening's entertainment, of course augmented with the annual performance of NSGIC's own band.

The Pyle Center is located next to the historic Red Gym and the UW Memorial Union, the "heart and soul" of the campus since 1928. At the Union you can enjoy a scoop of the renowned campus produced "Babcock Ice Cream" while taking in the views sitting on one of the colorful sunburst chairs on the Union's lakeside Terrace. Walkways between the Terrace and Pyle Center provide a great place for people watching, evening strolling, and gorgeous lake views. NSGIC will provide transportation to and from the Pyle Center, or you can choose to walk the eight blocks taking in the sights and sounds of historic and vibrant State Street along the way.

9:30 p.m. – 12 midnight

Hospitality Suite (open to all registrants)

Promenade Lounge – The Overture Center for the Arts

The Overture Center is one block from the Concourse. Exit the front door of the hotel, turn left and walk down

West Dayton St. to the intersection with State St. The Overture Center is the building straight ahead with the glass dome. Enter the front door and take the stairs or elevator in the Lobby to the second floor. The Promenade Lounge is to the left. – Thank you to this evening's sponsor: **Intermap Technologies**

Wednesday, Sept. 26

7 a.m. – 5 p.m.

Registration

Ballroom Foyer, Second Level

7 a.m. – 8:30 a.m.

Breakfast Provided

Madison Ballroom, Second Level

8:30 a.m. – 9:30 a.m.

Keynote Panel

Moderator: Stu Davis, State of Ohio, NSGIC President; Pat Cummins, ESRI
Presenters: Cy Smith, State of Oregon; Ivan DeLoatch, FGDC; Governor Jim Geringer, ESRI

The National Spatial Data Infrastructure (NSDI) has become an amorphous term for many, and for others it has become a justification to simply pursue the business needs of their individual agencies and businesses. We have never developed any absolute "right" or "wrong" ways to build the NSDI, but changes are imminent in the ways that we will work together to build the NSDI in the future. The Geospatial Line of Business will reshape the way Federal agencies work together to build their component pieces, and the National Geospatial Advisory Committee will provide the first opportunity for non-federal stakeholders to have an official voice in Federal activities. This session will examine the respective roles of the Federal government, business, and state governments. It will offer some thought-provoking views on the ways that we should be working together in the future, and maybe why we should simply be taking care of our own business needs to become better partners. A series of three presentations will be offered and they will be followed by an interactive session involving the audience.

9:30 a.m. – 10 a.m.

AmericaView – A State-Based Remote Sensing Initiative in Partnership with the U.S. Geological Survey (USGS)

Moderator: Stu Davis, State of Ohio, NSGIC President

Presenter: Sam Batzli, WisconsinView Program Manager and Vice Chairman of the Board of AmericaView

The AmericaView (AV) Program, a partnership between the U.S. Geological Survey and the AmericaViewSM Consortium, is a national program currently active in 30 states that was created to advance the availability, timely distribution, and widespread use of land remote sensing data. The Consortium is the federal government's primary partner in achieving the AV Program vision and goals, which focus on helping the academic, government and industry sectors in each state identify, develop, and distribute the kinds of remote sensing applications each state needs most. The AmericaViewSM Consortium is comprised of university-led, state-based consortia working together to build a nationwide network of state and local users.

10 a.m. – 10:30 a.m.

Break and Corporate Sponsor Exhibits

University Ballroom and Foyer, Second Level

10:30 a.m. – 11:30 a.m.

GIS In Healthcare

Moderator: Ted Koch, State of Wisconsin; Pat Cummins, ESRI

- **California's Experience with GIS in Healthcare**
Presenter: Michael Byrne, California Office of Statewide Health Planning and Development

California has a rich experience implementing Geographic Information Systems for a wide range of business process and content areas. Healthcare, however, provides a business case unlike any other. In California approximately 30% of the State Budget (not including the prison industry) is spent on healthcare.

This presentation will outline steps California is taking to ensure GIS technology is getting the most return in healthcare. Topics covered will include:

- Healthcare Shortage Area designation (a \$500 million annual business case in California)
 - Patient data warehousing
 - Telemedicine Planning
 - Community health needs assessment
 - Strategic line of service planning
 - Market analysis
 - Public Health analysis
- **The Real eHealth: Connecting People, Places and Policy: Informing Better Health Decisions Through GIS At Any Level, By Anyone**
Presenter: Governor Jim Geringer, ESRI

Twenty-four states have passed 36 health IT bills, and 11 governors have issued executive orders covering health IT in the past two years according to Terri Takai, Michigan CIO. The National Governors Association has formed the Alliance for eHealth to consider what initiatives the states should adopt to assure better health, patient care, assure fewer mistakes and improve health practices enabled through various electronic, digital and technology means.

Health care and prevention of disease are fundamentally determined as a matter of place, guided by location based information. Health care providers, Governors and other policy makers depend upon having the right information at the right time to make the right decision. Shouldn't they be more interested in the decision support capability of Geographic Information Systems? What priority will GIS and Information Technology have in state budgets? How will providers and state data systems communicate appropriately?

CONFERENCE AGENDA

Health care facilities, the means by which health care networks and emergency systems are built, the way disease outbreaks are observed, the way our safety is protected — all these things depend on intelligent, geographically referenced information systems. Data needs a geo-reference. Location matters. Geography matters. The science, the technology, the tools, the infrastructure and the data that enable them should be available to us as individuals as well as to providers and elected decision makers. We are better positioned than ever to manage the complex health care issues that we have within our communities, our state and our nation if we can learn to think and act spatially.

11:30 a.m. – 12 noon

**Platinum Sponsor Presentation:
Intermap Technologies – Nationwide
Elevation Data – Fit for Purpose**

**Moderator: Cy Smith, State of Oregon
Presenter: Brian Bullock, President &
CEO**

What is the state of the nation's elevation data? What quality and cost options do we have when acquiring up-to-date information? Currently there is a patchwork of data available throughout the country that ranges from very old and inaccurate to very recent and accurate. How do we determine what data is "fit for purpose" and where we invest? While 6 cm terrain data may be fit for San Francisco — it may not be fit for parts of rural Wyoming. Mr. Bullock's vision for the industry paints a future where all parties benefit — GIS professionals, industry, states, counties — and taxpayers.

12 noon – 1:30 p.m.

Lunch Provided

Madison Ballroom, Second Level

1:30 p.m. – 2 p.m.

**GIT Governance: State Models and
Best Practices**

**Moderator: David Mockert, GeoAnalytics
Presenter: Lea Shanley, University of
Wisconsin-Madison**

The landscape for coordinating and assessing geospatial activities within the State of Wisconsin changed dramatically in 2005 with the abolishment of the Wisconsin Land Information Board (WLIB), the preeminent coordination group in the state, and the entity that set policy and approved grants within the context of the Wisconsin Land Information Program (WLIP). Despite this setback, Wisconsin is addressing many of the nine criteria of the NSDI Future Directions Fifty States Initiative. The State hired its first Geographic Information Officer (GIO) in 2005, developed a statewide strategic plan in 2006, and is now in the process of creating a new Wisconsin Geographic Information Coordination Council. As part of this effort, we conducted extensive research into the evolution and status of governance structures for statewide coordinating mechanisms in eight other states. This presentation will summarize the results of this study, including a comparison of enabling mechanisms, membership and by-laws that govern council operations.

2 p.m. – 3 p.m.

Gold Sponsor Presentations

Moderator: Cy Smith, State of Oregon

- **Woolpert**

**Presenter: Rick Hammond, Client
Services Representative**

Woolpert will first familiarize the audience with our company, its resources, services, and its clientele. We will then discuss and update our statewide efforts, and how our clients are deploying geospatial information across their organizations. In addition, Enterprise Information Management (EIM) using geospatial solutions and the advantages of this approach will be discussed.

- **Places2Protect — “Inside Critical Points of Interest”**
Presenters: Eddie Pickle, Chief Operating Officer, Ionic Enterprises & Mary English, Director of Strategic Alliances, MCH Geo-Points

Numerous sources provide “points of interest” (POI) location data. With current GPS technology, it is easier than ever to affix geographic coordinates to POIs. However, the next generation of location-based applications require more than the element of place. Emergency management, planning, routing, and other applications require facility attribute details that provide descriptive information about POIs, such as: What is the facility used for and what does it provide? What populations use the facility and when? Who are the points of contact at the facility? This presentation discusses the possibilities for increasing the value of POI data with special emphasis on its application to public agencies for emergency management planning, response, and recovery.

- **Intergraph Corporation — “Is your Imagery ... Emergency Ready?”**
Presenter: David Kingsbury, Executive Technical Director

In this time of severe weather and possible disasters, it is critical to capture aerial and satellite imagery immediately and make it available to emergency response analysts in minutes ... not hours or days. The technology to do this is available today — and with immediate access and display. This type of optimal rapid access to imagery can support response analyses and decisions within emergency situations better than ever before. Learn what states can do to deploy this technology statewide to be “Emergency Ready with the latest Imagery.”

- **LizardTech — “Image Management and Distribution”**
Presenter: Terry Ryan, Federal Manager Geospatial Sales

3 p.m. – 3:30 p.m.

Transportation for the Nation Roundup
Moderator: Dan Widner, Commonwealth of Virginia; Frank Winters, State of New York

Session will provide a summary of TFTN activities over the past year, discuss NSGIC representation on a related committee sponsored by the Transportation Research Board (TRB), and discuss TFTN plans for the coming year.

3:30 p.m. – 4 p.m.

Break and Corporate Sponsor Exhibits
University Ballroom and Foyer, Second Level

4 p.m. – 5:30 p.m.

Homeland Security

Moderator: Jon Gottsegen, State of Colorado

- **Arizona Geospatial Clearinghouse**
Presenter: Gene Trobia, State of Arizona

The Arizona Geospatial Clearinghouse (AGC) is a statewide clearinghouse for geospatial data that can be shared with governmental agencies throughout Arizona. In addition, the Arizona Counter Terrorism Information Center (AcTIC) will be able to harvest transactional data from the Clearinghouse as needed. The Clearinghouse is based on the model proposed by NSGIC in a white paper several years ago. The State Cartographer’s Office is working closely with the AcTIC to establish and maintain the AGC.

- **DHS Geospatial Data Model: Content and Use**

Presenter: Michael Lee, FGDC, Homeland Security Working Group

The FGDC HSWG Content Subgroup is providing public review and comment support for the DHS Geospatial Data Model. The DHS

CONFERENCE AGENDA

GDM is a logical data model that will be implemented by the DHS for the development and exchange of geospatial data within the Department.

- **The National Guard ... Military Support to Civilian Authorities**
Presenters: Charles Cobb, Major, National Guard Bureau; Rob Barber-Delach, Domestic Operations GIS Program Manager, National Guard Bureau

This presentation will provide an overview of the National Guard, its role in support of homeland security missions, and its geospatial staffing and capabilities within the U.S. States and Territories. In a disaster scenario operations, Intel, and GIS staff in the State(s) are often providing map products in support of Guard operations. Coordinating with State civilian GIS/geospatial staff in advance of a disaster can be key to having the best data available and to effectively working with other agencies.

6 p.m.
Dinner on own or Taste of the Town — an evening of great Madison dining

“Taste of the Town” offers you the opportunity to join with a small group to enjoy dining in one of Madison’s fine downtown restaurants. Hosts for this evening have personally selected their favorite restaurant within walking distance of the Concourse Hotel, and will be your guide to the restaurant. Choices include ethnic (German, Irish, Italian, and Middle Eastern), a well-known brew-pub, several fine dining establishments, and a State Street pub specializing in Wisconsin brats, cheese and beer. Taste of the Town offers something for everyone that will surely tempt your taste buds. Following dinner you may regroup with NGSIC friends at the Hospitality Suite located in the Overture Center one block from the hotel. A brochure providing restaurant descriptions, host recommendations, and price ranges will be included with conference

registration materials. A sign-up list for each restaurant will be available at the conference registration center.

9:30 p.m. – 12 midnight
Hospitality Suite (open to all registrants)

Promenade Lounge – The Overture Center for the Arts

The Overture Center is one block from the Concourse. Exit the front door of the hotel, turn left and walk down West Dayton St. to the intersection with State St. The Overture Center is the building straight ahead with the glass dome. Enter the front door and take the stairs or elevator in the Lobby to the second floor. The Promenade Lounge is to the left. Thank you to this evening’s sponsor: **Fugro EarthData**

Thursday, Sept. 27

7 a.m. – 5 p.m.

Registration

Ballroom Foyer, Second Level

7 a.m. – 8:30 a.m.

Breakfast Provided

Madison Ballroom, Second Level

8:30 a.m. – 9 a.m.

Federal Contracts Open to State & Local Partners

Moderator: John Palatiello, Executive Director, Management Association for Private Photogrammetric Surveyors

Several Federal agencies, including NOAA, USGS, NGA and USACE have contracts in place with multiple professional firms to provide geospatial data and services that can be offered to State and local government agencies through a Memorandum of Agreement or other similar mechanisms. These contracts can offer capabilities and options to state and local agencies that are in addition to or in lieu of their own contracting mechanisms. In this session, Federal agency representatives will briefly describe their programs, state officials will share their experience using these contracts, and private firms will explain how they help coordinate participants for win-win-win outcomes.

9 a.m. – 9:30 a.m.

Vertical Control Issues

Moderator: Ted Koch, State of Wisconsin

Presenter: Dave Zilkoski, Director, Office of National Geodetic Survey

This presentation provides a historical overview of NOAA's National Geodetic Survey, currently celebrating 200 years of service to the Nation. NGS products and services serve geospatial needs by providing both horizontal and vertical positions accurate to 2-3 cm measured over time. Topics include the NGS 10-Year plan, the National Spatial Reference System, NGS' state advisor program, Height Modernization Program, the GPS Continuously Operating Reference System Opus Positioning User Service, and other GIS-specific tools.

9:30 a.m. – 10 a.m.

Great Lakes Regional Information Network

Moderator: Ted Koch, State of Wisconsin

Presenter: Pete Giencke, Lead Developer, Data & Information Management Group, Great Lakes Commission

The Great Lakes Information Network (GLIN) GIS Clearinghouse (<http://gis.glin.net>) is an open source-based suite of tools designed to facilitate the publication and dissemination of Great Lakes-themed datasets. Through the GLIN GIS, registered users and organizations can publish and get hosted their Great Lakes-related geospatial data, free of charge. Uploaded data automatically gets converted into both OGC Web services (i.e. WFS, WMS) and a variety of file formats (e.g. GML, KML, SHP). Metadata for each layer is checked for FGDC-compliance and subsequently published to Geospatial Onestop (GOS) for greater discovery and distribution. The GLIN GIS also provides tools for web mapping, a map gallery, and links to additional Great Lakes data resources.

10 a.m. – 10:30 a.m.

Break and Corporate Sponsor Exhibits

University Ballroom and Foyer, Second Level

10:30 a.m. – 11:30 a.m.

Getting the Results You Expect: Forging Productive Partnerships and Executing Better RFP's
NSGIC Corporate Leadership Council (CLC)

Successful partnerships and well crafted RFP's will yield better results and will minimize headaches and hassles for both the government agency and private sector bidder. The NSGIC Corporate Leadership Council has joined forces to compile a wealth of information on preparing successful RFP's, understanding Terms and Conditions and alternative approaches for collaborative alliances. This session will kick off an on-going dialogue to work together, learn from each other, and strengthen public and private partnerships to improve results in GIS projects.

11:30 a.m. – 11:45 a.m.

Gold Sponsor Presentation

Moderator: Cy Smith, State of Oregon

- **Surdex**
Presenter: Craig W. Molander, Senior Vice President of Business Development

Surdex Corporation will first familiarize the audience with our 50+ year-old company, its resources and offerings, and its clientele. Part of the presentation will address thoughts on the consideration of imagery resolution for large projects, in light of recent advances in technology. Surdex has been responsible for numerous large projects in recent years using both film and digital acquisition methods.

11:45 a.m. – 12:15 p.m.

Funding Strategies for Statewide Orthophoto Projects

Moderator: Jim Lacy, State of Wisconsin

Presenters: Kenny Miller, State of Maryland; Jill Saligoe-Simmel, Indiana Geographic Information Council, Inc.

Imagery for the Nation is a key NSGIC initiative we all hope will move forward at the federal level. However, in the meantime, states must find creative ways to fund statewide orthophoto

CONFERENCE AGENDA

projects. In this session our speakers will briefly discuss their past successes in funding their state projects, and describe the strategies they hope will maintain sustainable funding into the future.

12:15 p.m. – 1:30 p.m.

Lunch Provided

Madison Ballroom, Second Level

1:30 p.m. – 2 p.m.

Business Meeting 2

Moderators: Cy Smith, State of Oregon; Stu Davis, State of Ohio, NSGIC President

This time is reserved to continue the Business Meeting if it is required to complete the agenda. Attendance at this session by State Representatives is important to provide a quorum for voting. After the completion of the Business Meeting, the closing ceremonies will conclude the business portion of this year's Annual Conference.

2 p.m. – 5 p.m.

State Caucus Part 2

Moderators: Tony Spicci, State of Missouri; Bill Burgess, NSGIC Washington Liaison

This session simply picks-up where we left off in the discussions during the first State Caucus on Sunday. State and local government members meet in private to discuss topics not covered in the first caucus and have an opportunity to add additional items for discussion.

2 p.m. – 5 p.m.

USGS NGPO Meeting

Moderator: John Mahoney, US Geological Survey

Assembly Room, Lobby Level

3:30 p.m. – 4 p.m.

Break and Corporate Sponsor Exhibits

University Ballroom and Foyer, Second Level

6 p.m. – 9 p.m.

New Board Meeting

Moderator: Cy Smith, State of Oregon

Senate Room, Lobby Level

Open to all

9:30 p.m. – 12 midnight

Hospitality Suite (open to all registrants)

Promenade Lounge – The Overture Center for the Arts

The Overture Center is one block from the Concourse. Exit the front door of the hotel, turn left and walk down West Dayton St. to the intersection with State St. The Overture Center is the building straight ahead with the glass dome. Enter the front door and take the stairs or elevator in the Lobby to the second floor. The Promenade Lounge is to the left.



**See you at NSGIC's
2008 Events!**

Midyear Conference

March 9-12, 2008

Annapolis, Maryland

Annual Conference

September 7-11, 2008

Keystone, Colorado